

COVER-ALL'S

GEMINI BUILDING SERIES (GBS) 70' – 140' wide (21.3m – 42.7m)

Building Features

The Cover-All® Gemini™ Building Series (GBS) offers tremendous strength and durability in a massive clear-span space, and is designed to meet the needs of large operations. Engineered for use worldwide and rated for wind and snow loads, Gemini™ buildings maintain structural integrity even under unbalanced conditions. Extensive ongoing tests of the engineering and individual components ensure that each structural part is complimentary in weight and strength and, in combination, create a sound, secure steel framework. Gemini™ buildings can be fully constructed in just weeks.

Models and Sizes Available

Cover-All® Gemini™ buildings are available in widths from 70 to 140 feet (21.3m to 42.7m), and can be manufactured to any length. The modular design allows you to extend the building to meet your changing needs. Engineer-sealed drawings are available for all Gemini™ models ensuring building integrity is certified and satisfying local codes and permit requirements. Individual custom drawings are also available.

Gemini™ Building Series - Widths: 70', 80', 90', 100', 110', 120', 130', 140' (21.3m, 24.4m, 27.4m, 30.5m, 33.5m, 36.6m, 39.6m, 42.7m)
Constructed of welded truss arches with parallel 3" (7.6cm) square steel tubes spaced 53" (134.6cm) apart and strengthened by 1.9" (4.8cm) diameter structural webbing.

Main structural support trusses are continuous from the ground seal to the peak and manufactured with an integrated eave. The eave can be specified up to 4' to fit many applications. There are no exterior purlins and the structure is completely clear-span with no interior supports.

Building Profile

For detailed specifications including outside width, inside width, and bay spacing contact your local Dealer.

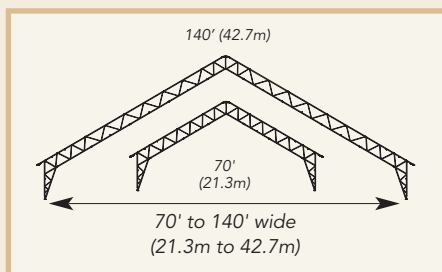

110' w x 180' l (33.5m x 54.8m)

Building Materials

DuraWeave® Fabric Covers

Cover-All's high performance DuraWeave® covers are virtually maintenance free. The patented double stack weave provides unmatched strength to weight ratios. The patented WinchLoc™ system provides unparalleled cover-fastening strength. With a series of 10,000 lb. winches and zero-stretch belting, covers stay tight and secure. DuraWeave® and DuraWeave® FR covers are backed by 15 and 10 year pro rata warranties respectively. PVC fabric is available on request.

ViperSteel® Framework

Our framework is constructed with ViperSteel® and clad with triple coated Gatorshield® corrosion barrier. Independent salt spray tests show that Gatorshield® provides a service life three times longer than conventional galvanized steel. All welds are shotblasted and finished with a state-of-the-art molten zinc anti-corrosion process unique to Cover-All. Steel framework is backed by the same outstanding 15 year limited pro rata warranty as our DuraWeave® covers

Foundation Options

Foundation options are varied and may include, but are not limited to: concrete piles, floating blocks, concrete or steel walls, and earth anchors. Specific foundation applications are dependent on site conditions. Refer to a foundation engineer for the specific requirements for your building project.

Dealer Network

Your local authorized Cover-All Dealer is part of a worldwide product support network that will provide you with service and support for all your building needs - before, during and after your building installation.



120' w x 240' l (36.5m x 73.1m)



100' w x 260' l (30.4m x 79.2m)

COVER-ALL'S

GEMINI BUILDING SERIES (GBS) 70' – 140' wide (21.3m – 42.7m)



100' w x 260' l (30.4m x 79.2m)



110' w x 180' l (33.5m x 54.8m)



120' w x 240' l (36.5m x 73.1m)



100' w x 260' l (30.4m x 79.2m)



110' w x 180' l (33.5m x 54.8m)



100' w x 260' l (30.4m x 79.2m)



110' w x 180' l (33.5m x 54.8m)



100' w x 260' l (30.4m x 79.2m)

North America: 1.800.268.3768 • UK: 0800 3891490 • outside NA & UK: +44 (0)1270 620 475 • web: www.coverall.net



720406 / 1923-07 / ENG COVER-ALL, GEMINI, DURAWEAWE, VIPERSTEEL AND WINCHLOC ARE TRADEMARKS OR REGISTERED TRADEMARKS OF COVER-ALL BUILDING SYSTEMS/GATORSHIELD IS A REGISTERED TRADEMARK OF ALLIED TUBE AND CONDUIT